

Bluetooth & Analog Audio Dante® Wall Plate US

Description

The DA11ABL-WP-US-V2 is a multi-input / output wall plate to convert Bluetooth and analog audio within a digital Dante® networked audio system. The DA11ABL-WP-US-V2 converts 2 input channels of Bluetooth or unbalanced audio to Dante® digital audio, and 2 channels of Dante® audio to 2 x output channels of unbalanced audio.

The DA11ABL-WP-US-V2 is a plug & play device that is powered using PoE (Power over Ethernet), or via 12V power supply, offers support for AES67 RTP audio transport and magnetic faceplate design allows installation into most single-gang US junction boxes. The DA11ABL-WP-US-V2 is the ideal BYOD interface to allow any Bluetooth device to stream audio wirelessly to a Dante® audio system.

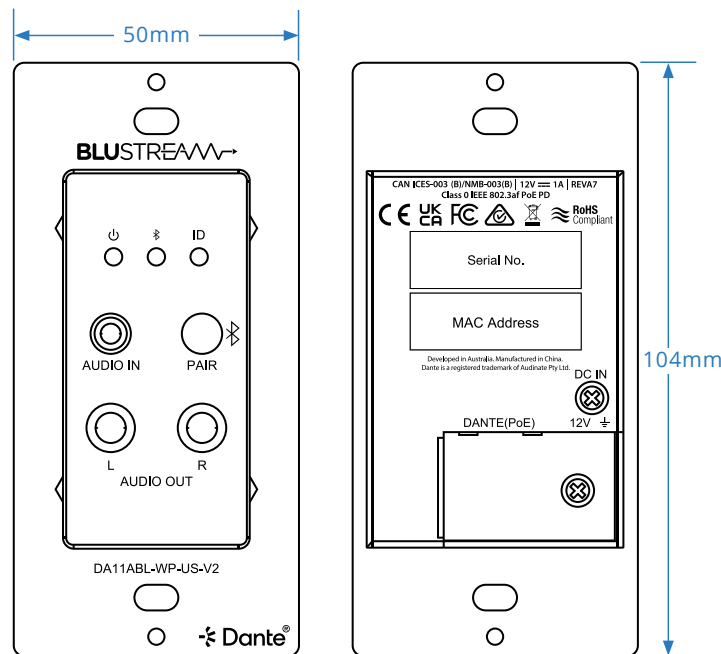

Key Features

- Dante® network wall plate interface for Bluetooth and analog L/R audio inputs, and L/R audio outputs
- Converts 2ch Bluetooth, or un-balanced audio sources to Dante® audio
- Converts 2x Dante® audio channels to un-balanced audio outputs
- Adjustable input sensitivity from +24dBu to -28dBV (analog audio only), and output gain from +20dBu to -28 dBV via web GUI or API
- Dante® Audio Supports 44.1, 48, 88.2 & 96KHz sample rates @ 16, 24 & 32-bit
- Configurable Dante® device latency (supports 2, 3, 4, 5 or 10ms configurable using Dante® Controller)
- Supports AES67 RTP audio transport
- Features Class 0 IEEE 802.3af PoE for powering of product from any PoE switch
- Supports power via 12V DC adapter (not included) for when network switch does not support PoE
- White magnetic faceplate surround and US Decora style backbox compatibility
- In-built web-GUI for configuration and control

*Dante® is a registered trademark of Audinate Pty Ltd

Blustream cannot be held responsible for errors in typography or photography. Specifications are subject to change without notice.



Specifications

- **Module Dimensions (W x H x D):** 50mm x 104mm x 48mm (without faceplate)
- **Faceplate Dimensions (W x H x D):** 70mm x 155mm x 5mm
- **Cut Out Dimensions (W x H x D):** 46mm x 56mm x 39mm
- **Mounting Hole Spacing:** US 83mm CTC
- **Backbox Requirements:** US single gang junction box
- **Shipping Weight:** 0.42kg
- **Operating Temperature:** 32°F to 104°F (0°C to 40°C)
- **Storage Temperature:** - 4°F to 140°F (- 20°C to 60°C)
- **Power Supply:** Class 0 IEEE 802.3af PoE or 12V/1A DC 2-Pin Phoenix connector

Connectivity

- **Audio Input Connections:** 1 x Analog Left / Right audio (3.5mm stereo jack)
- **Audio Output Connections:** 2x Analog RCA (Left / Right)
- **Network Connection:** 1 x PoE Dante® Ethernet Connection (RJ45)
- **Bluetooth:** Bluetooth V5.0 - SBC / MP3 / AAC / APT-X / APTX-LL / APTX-HD, 44.1K-48KHz 16 / 24-bit

Included Accessories

Faceplate	1 x Magnetic Faceplate
------------------	------------------------

Acknowledgements

Dante® is a registered trademark of Audinate Pty Ltd.

Regulatory Compliance



Blustream cannot be held responsible for errors in typography or photography. Specifications are subject to change without notice.