

Example Schematic
UEX3D / UEX3H

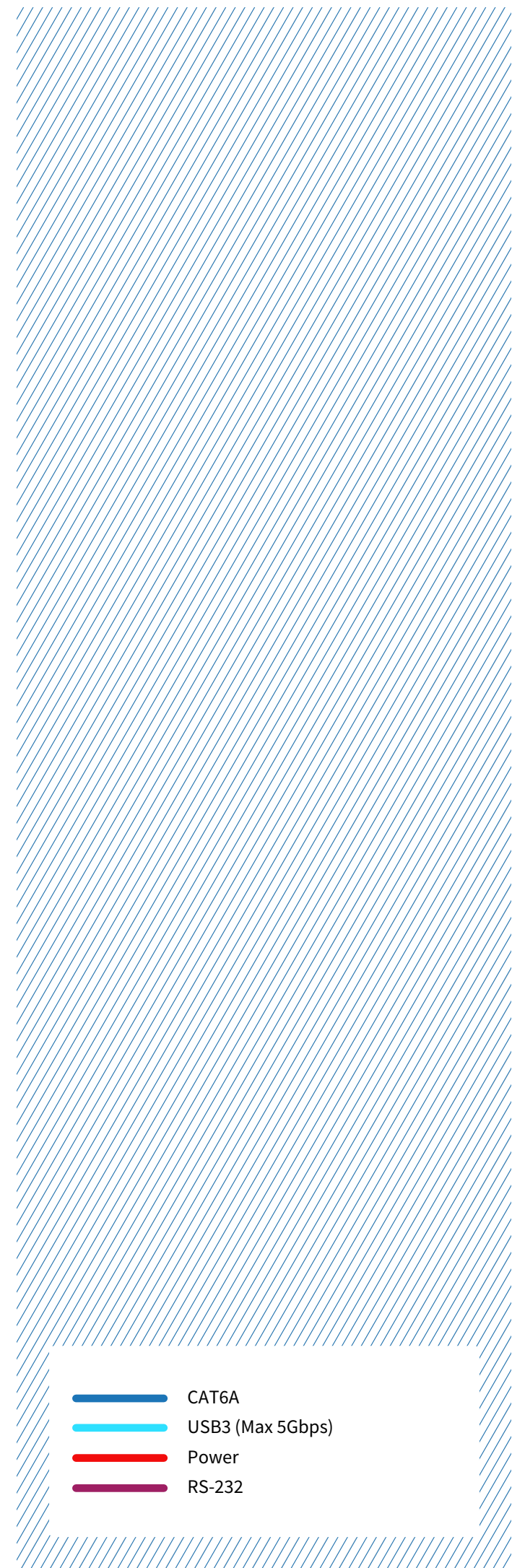

***Please note: Host end is compatible with the UEX3D, UEX3D-WP-EU, or UEX3D-WP-US**

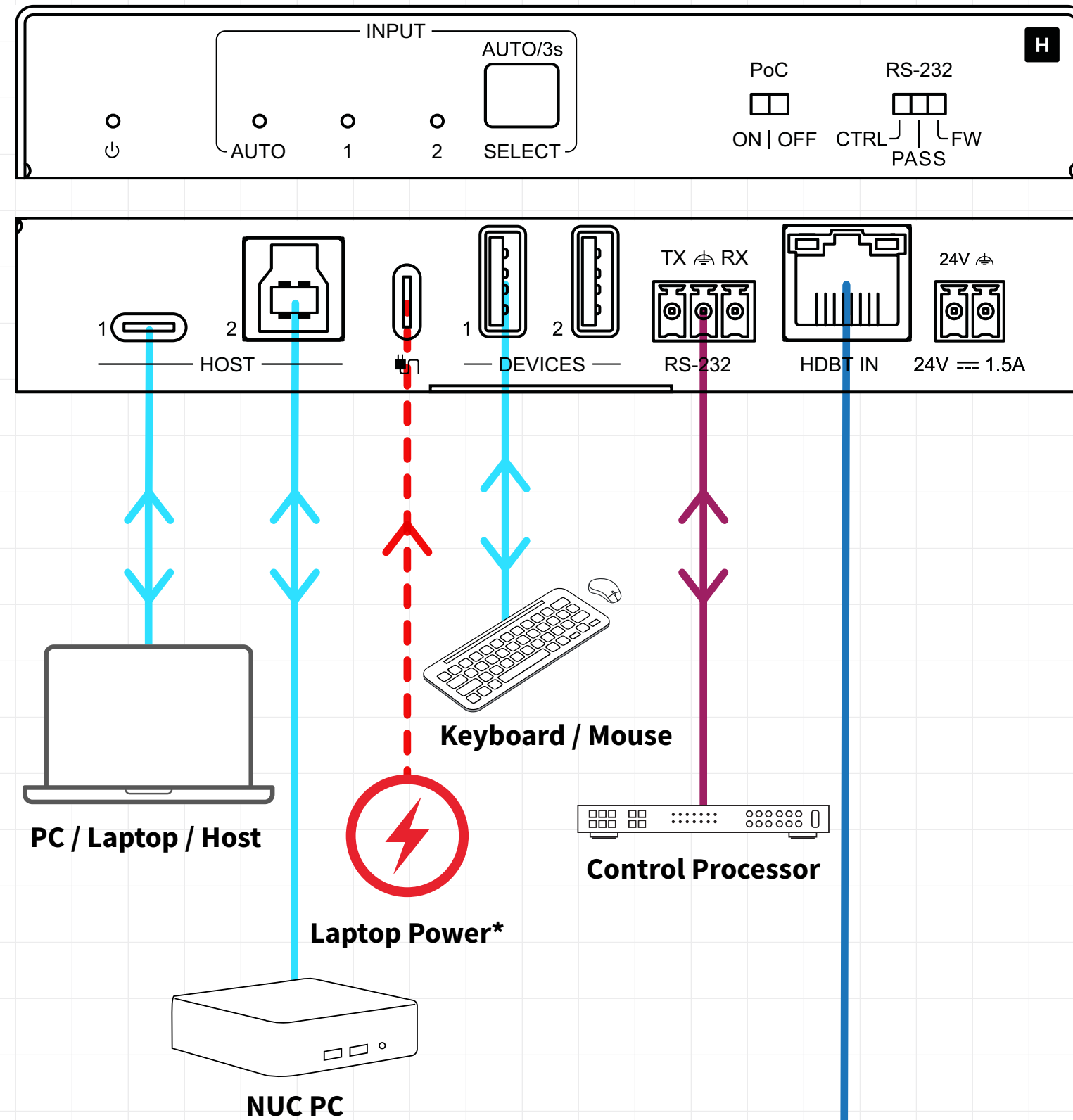

***Please note: Device end is compatible with the UEX3H, UEX3H-WP-EU, or UEX3H-WP-US**

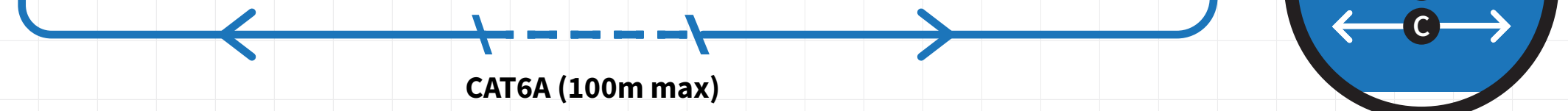
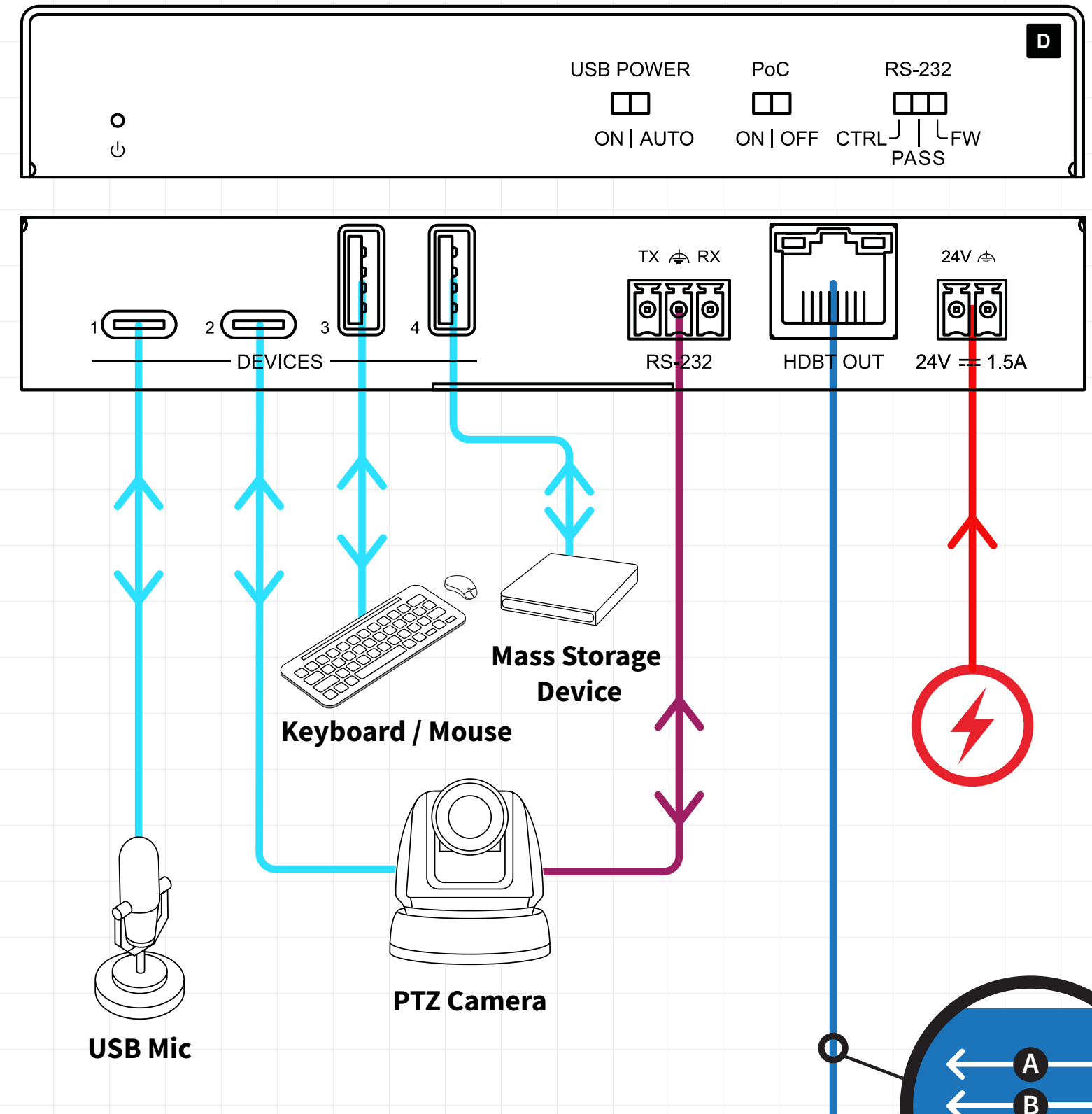

- Ⓐ USB3.2 Gen1
- Ⓑ PoC
- Ⓒ RS-232

- CAT6A
- USB3 (Max 5Gbps)
- Power
- RS-232

***PSU not included for the Laptop Power Connection**